

**ZEEC**



# **Owner's Manual Supplement**

[www.seafoxboats.com](http://www.seafoxboats.com)

## **SEA FOX BOAT'S DISCLAIMER**

The following Owner's Manual is provided for information and educational purposes only and is not intended to offer or provide legal advice or create a contractual relationship between Sea Fox Boat Company and the owner of any Sea Fox brand vessel. Please beware that as a vessel owner you have non-delegable responsibilities regarding the safety, maintenance, fitness, and operation of your vessel and the extent of such responsibilities is ultimately determined by Federal law and regulations, the general maritime law of the United States, the laws and regulations of the states and territories of the United States, or the laws and regulations of the country where you operate your vessel. To fully understand your responsibilities as a vessel owner, and before operating or letting any third-party operate your vessel, we recommend that you consult the services of a qualified lawyer in admiralty and maritime law.

## TABLE OF CONTENTS

Introduction . . . . .	3	Harness Nav LT LG w/Deutsch (P/N 6121) . . . . .	14
Specifications . . . . .	3	Accessory Harness . . . . .	15
Designated Occupant Seating . . . . .	4	Harness Kicker Only 6-Speaker . . . . .	16
Safety Decals . . . . .	5	Harness JL 6-Speaker . . . . .	17
Plumbing Schematics . . . . .	7	Main Switch Panel . . . . .	18
Commander Bilge Pumps . . . . .	7	JL Audio Breaker Panel . . . . .	19
Commander Drains . . . . .	8	JL AMPLIFIER PIG TAIL KIT . . . . .	20
Commander Waste System . . . . .	9	Harness Mood Light w/Deutsch (P/N 6128) – Optional . . . . .	21
Commander Fresh Water System . . . . .	10	Harness Windlass Hull Aft Battery (P/N 6134) – Optional . . . . .	22
Commander Fuel System . . . . .	11	Harness Windlass Deck Option (P/N 6135) – Optional . . . . .	23
Electrical Schematics . . . . .	12	Head Panel Switch ORB (P/N 6136) – Optional . . . . .	24
Single Engine with Two-Battery Setup . . . . .	12	AFT MAIN BREAKER PANEL . . . . .	25
Twin Engine with Three-Battery Setup . . . . .	13	uLTIMA Top Switch/Harness (P/N 7277) – Optional . . . . .	26

This Page Intentionally Left Blank

## INTRODUCTION

**Congratulations and Welcome Aboard!** With so many boat brands to choose from, we want to congratulate you on your decision to choose Sea Fox Boats. For more than 24 years, Sea Fox offers the finest hand-crafted saltwater boats carefully balanced with the build-quality, features, styling and performance for the fairest price. Our passion for boating is evident in every model we make and we appreciate that you've noticed the Sea Fox difference.

We share your love for the moments spent on the water with friends and family, which is why every Sea Fox boat offers a unique blend of fishing/family options, technologies and innovative features. Your choice of a Sea Fox affirms that you have performed your research and compared the value of your model with the competition.

Whether you are new to the boating lifestyle or an old salt, we ask that **you and all other operators** read the owner's manual, this supplement, and all other literature provided with the boat **before** operating the boat or any equipment. We also recommend that all operators enroll in a boating safety course available online - see References and Contact Information in this section for education resources online.

This supplement contains model-specific information not included with the owner's manual. This manual is not intended to be a replacement for specific product literature provided by engine, accessory or other major equipment manufacturers, but rather to supplement that information.

Because of our philosophy of continuous product improvement, this manual serves as a general guide only, so the specifications and illustrations used may not match the equipment on your boat and are intended only as general reference views.

*We welcome you to the Sea Fox family and wish you many years of boating enjoyment!*

## SPECIFICATIONS

Max. Weight Capacity	Yacht Certification
Persons	Yacht Certification
Persons Weight	Yacht Certification
Max. HP	400 hp (298 kw)
L.O.A.	26' (7.9 m)
Beam	9' 3" (2.8 m)
Draft	16 in. (0.41 m)
Height, Keel to Top (Light Folded)	118 in. (3 m)
Bridge Clearance Hard Top	102 in. (2.59 m)
Max. Weight Boat (w/ Fluids, Largest HP)	7850 lbs (3561 kg)
Fuel Tank Capacity	140 gal (530 L)
Freshwater Tank Capacity	12 gal (45 L)
Holding Tank Capacity	12 gal (45 L)

## DESIGNATED OCCUPANT SEATING

Be sure all passengers are properly seated in designated seating positions and not riding on the bow, bow pulpit, deck, gunwale or rear sun deck while underway. Passengers must use hand-holds and use caution when riding in the bow. Move to the aft passenger seats during rough water operation or if visibility is restricted.

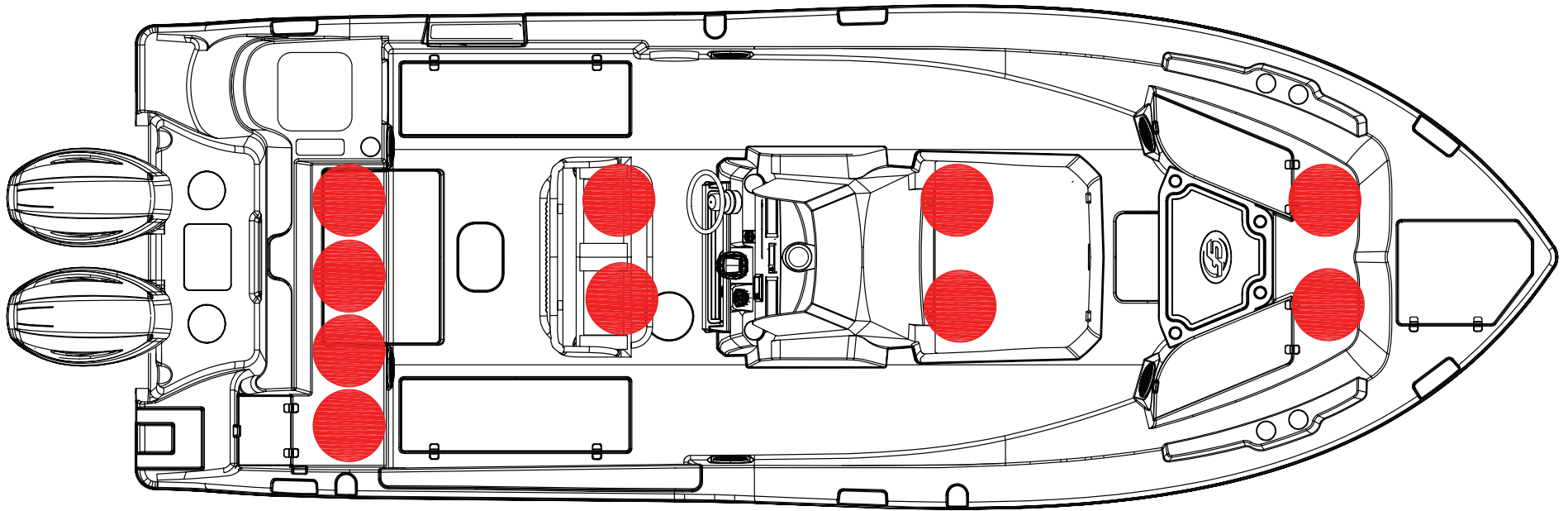

● = Seat position

SFOX-0024

## SAFETY DECALS

**SEA FOX**  
BOAT WORKS  
YACHT CERTIFICATION  
THIS BOAT COMPLIES WITH THE U.S. COAST GUARD SAFETY STANDARDS IN EFFECT ON THE DATE OF CERTIFICATION  
SEA FOX BOAT COMPANY  
MONCK'S CORNER, S.C.

**WARNING**  
Moving parts can crush and cut. Keep hands clear while operating bracket. U38076-01

**WARNING**  
Moving parts can crush and cut. Keep hands clear while operating bracket. U38076-01

**WARNING**  
Moving parts can crush and cut. Keep hands clear while operating bracket. U38076-01

**NON POTABLE WATER**

**NON POTABLE WATER**

**WARNING**  
AVOID PERSONAL INJURY SECURE GATE/DOOR & DO NOT BE OUTSIDE GATE/DOOR WHEN BOAT IS UNDERWAY. U38070-01

**WARNING**

Failure to follow these warnings could cause severe injury or death

- WEAR SAFETY LANYARD at all times while operating boat to prevent unmanned boat operation.
- NEVER OPERATE WHILE UNDER THE INFLUENCE of drugs or alcohol.
- DO NOT OVERLOAD THE BOAT. ENSURE THAT WEIGHT IS PROPERLY AND EVENLY DISTRIBUTED fore and aft and on both sides of the boat to avoid poor handling sudden loss of control, swamping and/or capsizing.
- PASSENGERS SHOULD WEAR U.S. COAST GUARD APPROVED LIFE JACKETS.
- MAKE SURE THAT ALL PASSENGERS ARE PROPERLY SEATED WHILE UNDERWAY. To avoid passengers falling overboard or being ejected from the boat, do not allow passengers to sit on seat backs, gunwales or outermost deck edges while boat is moving.
- REDUCE SPEED BEFORE ATTEMPTING TURN OR SHARP TURNS.
- AND MAINTAIN SAFE SPEEDS for water conditions and environment at all times. Maneuverability at high speeds is limited, and sudden turns may cause loss of boat control.
- KEEP PROPER LOOKOUT AND SAFE DISTANCE for the conditions at all times to avoid collisions.
- OBEY APPLICABLE NAVIGATION RULES AND BOATING LAWS.
- USE CAUTION AND PROPER LIGHTING during nighttime boating and boating in adverse weather.
- READ THE OWNER'S MANUAL AND COMPLETE THE BOATER'S PRE-OPERATION CHECKLIST prior to boat operation.

**NOTICE**  
SHUT OFF VALVE(S) LOCATED BEHIND ACCESS PANEL. CLOSE VALVE(S) WHEN NOT IN USE. U37628-02

**WARNING**  
**PINCH POINT**  
Watch your hands and fingers when opening and closing cover.  
AVOID PERSONAL INJURY SECURE GATE/DOOR WHEN BOAT IS UNDERWAY. ENSURE LADDER IS SECURED TO DECK PRIOR TO USING IF EQUIPPED. U38073-01

**WARNING**  
**PINCH POINT**  
Watch your hands and fingers when opening and closing cover.  
AVOID PERSONAL INJURY SECURE GATE/DOOR WHEN BOAT IS UNDERWAY. ENSURE LADDER IS SECURED TO DECK PRIOR TO USING IF EQUIPPED. U38073-01

**NOTICE**  
THIS BOAT IS EQUIPPED WITH AN OPTIONAL DIRECT OVERBOARD DISCHARGE VALVE. DISCHARGING OF SEWAGE DIRECTLY OVERBOARD IS FOR USE WHERE APPROVED ONLY. U38049-01

**WARNING** GAS / PETROL ONLY  
CONTENTS CAN BE UNDER PRESSURE. AVOID SERIOUS INJURY OR DEATH FROM FIRE OR EXPLOSION. OPEN SLOWLY IN WELL VENTILATED AREA. NO SMOKING OR OPEN FLAMES. U38088-01

**WARNING**  
Leaking fuel is a fire and explosion hazard. Avoid serious injury or death from fire or explosion from leaking fuel. Inspect system for leaks at least once a year.

Manufactured by  
**SEA FOX**  
BOAT WORKS

**NOTICE**  
SHUT OFF VALVE(S) LOCATED BEHIND ACCESS PANEL. CLOSE VALVE(S) WHEN NOT IN USE. U37628-02

**DANGER**  
ROTATING PROPELLER CAN CAUSE SERIOUS INJURY OR DEATH. SHUT OFF MOTOR WHEN NEAR PERSONS IN WATER. U38101-01

**NO WOOD! NO ROT!**

**WARNING**  
Operating, servicing and maintaining a recreational marine vessel can expose you to chemicals including engine exhaust, carbon monoxide, phthalates, and lead, which are known to the State of California to cause cancer and birth defects or other reproductive harm. To minimize exposure, avoid breathing exhaust, service your vessel in a well-ventilated area and wear gloves or wash your hands frequently when servicing this vessel. For more information go to [www.P65warnings.ca.gov/marine](http://www.P65warnings.ca.gov/marine). U38438-01

**FRESH WATER** **RAW WATER**

**DISCHARGE OF OIL PROHIBITED**

THE FEDERAL WATER POLLUTION CONTROL ACT PROHIBITS THE DISCHARGE OF OIL OR OILY WASTE INTO OR UPON THE NAVIGABLE WATERS OF THE UNITED STATES, OR THE WATERS OF THE CONTIGUOUS ZONE, OR WHICH MAY AFFECT NATURAL RESOURCES BELONGING TO, APPERTAINING TO, OR UNDER THE EXCLUSIVE MANAGEMENT AUTHORITY OF THE UNITED STATES, IF SUCH DISCHARGE CAUSES A FILM OR DISCOLORATION OF THE SURFACE OF THE WATER OR CAUSES A SLUDGE OR EMULSION BENEATH THE SURFACE OF THE WATER. VIOLATORS ARE SUBJECT TO SUBSTANTIAL CIVIL PENALTIES AND/OR CRIMINAL SANCTIONS INCLUDING FINES AND IMPRISONMENT.

**DANGER**  
ROTATING PROPELLER CAN CAUSE SERIOUS INJURY OR DEATH. SHUT OFF MOTOR WHEN NEAR PERSONS IN WATER. U38129-01

**DANGER**  
Carbon monoxide (CO) can cause brain damage or death. Engine and generator exhaust contains odorless and colorless carbon monoxide gas. Carbon monoxide will be around the back of the boat when engines or generators are running. Move to fresh air, if you feel nausea, headache, dizziness, or drowsiness. U38089-01

**BATTERY CHARGER**

**WARNING**  
Failure to follow these warnings could cause SERIOUS INJURY or DEATH.

- REMAIN PROPERLY SEATED AND HOLD ON to available handrails while boat is moving to avoid falling overboard or being ejected from the boat. Do not sit on seat backs, gunwales or outermost deck edges.
- WEAR U.S. COAST GUARD APPROVED LIFE JACKETS.
- DO NOT OVERLOAD THE BOAT. OCCUPANTS AND GEAR MUST BE PROPERLY AND EVENLY DISTRIBUTED fore and aft, and on both sides of the boat. Improper loading and/or overloading may result in poor handling, sudden loss of control, swamping and/or capsizing.
- REFER TO AND OBEY THE DESIGNATED OCCUPANT SEATING POSITIONS that are indicated by the manufacturer for your specific model.
- OBEY THE OPERATOR at all times.
- DO NOT RESTRICT THE OPERATOR'S VISION.
- DO NOT DEPART THE VESSEL without informing the operator.

It is illegal for any vessel to dump plastic ANYWHERE in the ocean or navigable waters of the United States. Annex V of MARPOL TREATY is an International Law for a cleaner, safer marine environment. Violation of these requirements is a Class D Felony and may result in a civil penalty, up to \$25,000 fine and imprisonment.

U.S. lakes, rivers, bays or sounds and 3 miles from shore	3 to 12 miles	12 to 25 miles	Outside 25 miles
<b>ILLEGAL TO DUMP:</b> Plastic	<b>ILLEGAL TO DUMP:</b> Plastic	<b>ILLEGAL TO DUMP:</b> Plastic	<b>ILLEGAL TO DUMP:</b> Plastic
<b>Plastic and Garbage</b>	Dunnage, lining and packing materials that float; also if not ground to less than one inch	Dunnage, lining and packing materials that float.	
Paper	Metal		
Rags	Crockery		
Glass	Dunnage		
Food	Paper		
	Rags		
	Glass		
	Metal		
	Food		

Regional state and local regulations may further restrict the disposal of garbage. The discharge of all garbage into the Great Lakes or their connecting or tributary waters is prohibited.

**WARNING**

Rotating propeller may cause serious injury or death. Shut off engine when near persons in the water.

Carbon monoxide (CO) can cause brain damage or death. Engine and generator exhaust contains odorless and colorless carbon monoxide gas. Signs of carbon monoxide poisoning include nausea, headache, dizziness, drowsiness, and lack of consciousness. Get fresh air if anyone shows signs of carbon monoxide poisoning. See Owner's Manual for information regarding carbon monoxide poisoning.

Leaking fuel is a fire and explosion hazard. Avoid serious injury or death from fire or explosion from leaking fuel. Inspect system for leaks at least once a year. U38074-01

SEA FOX BOAT COMPANY  
MEETS U.S. EPA EVAP STANDARDS USING CERTIFIED COMPONENTS

**WARNING**

**CARBON MONOXIDE (CO) CAN CAUSE BRAIN DAMAGE OR DEATH.**

-Carbon monoxide can be present in the cabin.  
-Signs of carbon monoxide poisoning include nausea, headache, dizziness, drowsiness, and lack of consciousness.

**MOVE TO FRESH AIR** if anyone shows signs of carbon monoxide poisoning.

**USE AVAILABLE HANDRAILS AND HANDHOLDS** while moving about the cabin and while the boat is in motion to avoid falling. U40419-01

- 1= COCKPIT FRONT
- 2= HEAD COMPARTMENT
- 3= CONSOLE
- 4= FUEL FILL
- 5= COCKPIT MID SHIP
- 6= COCKPIT AFT
- 7= TRANSOM GATE
- 8= DIVE DOOR
- 9=TRASOM

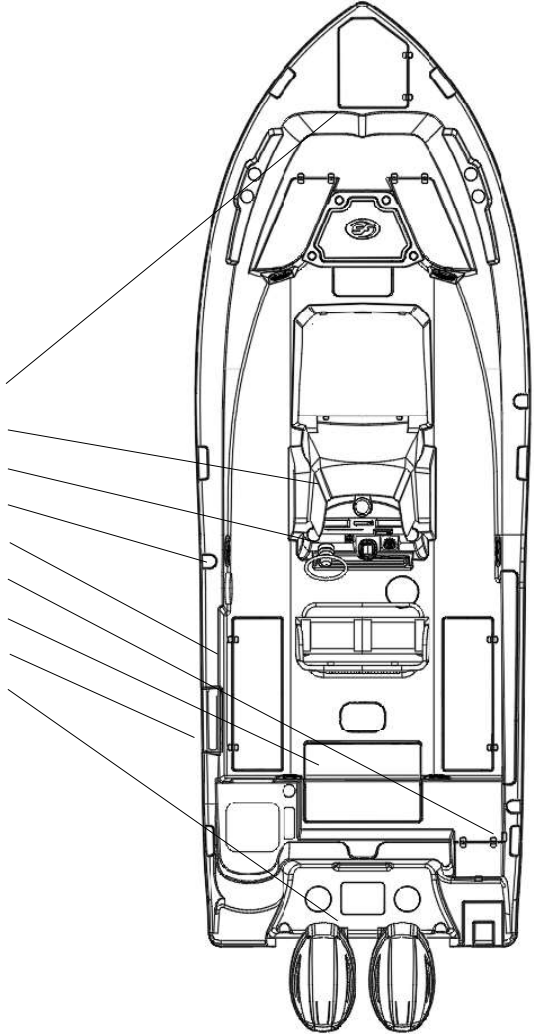



## PLUMBING SCHEMATICS

### COMMANDER BILGE PUMPS

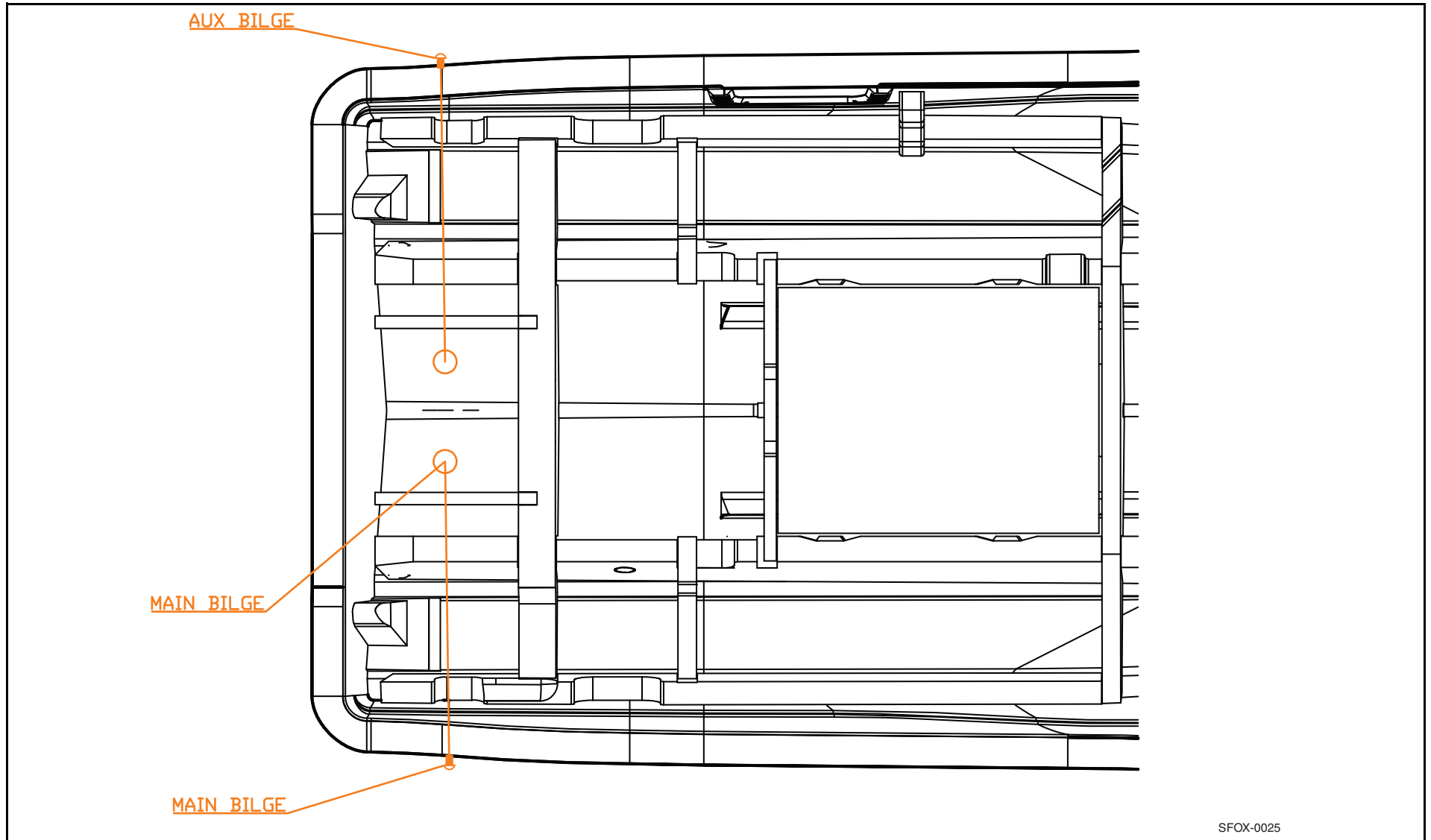

## COMMANDER DRAINS

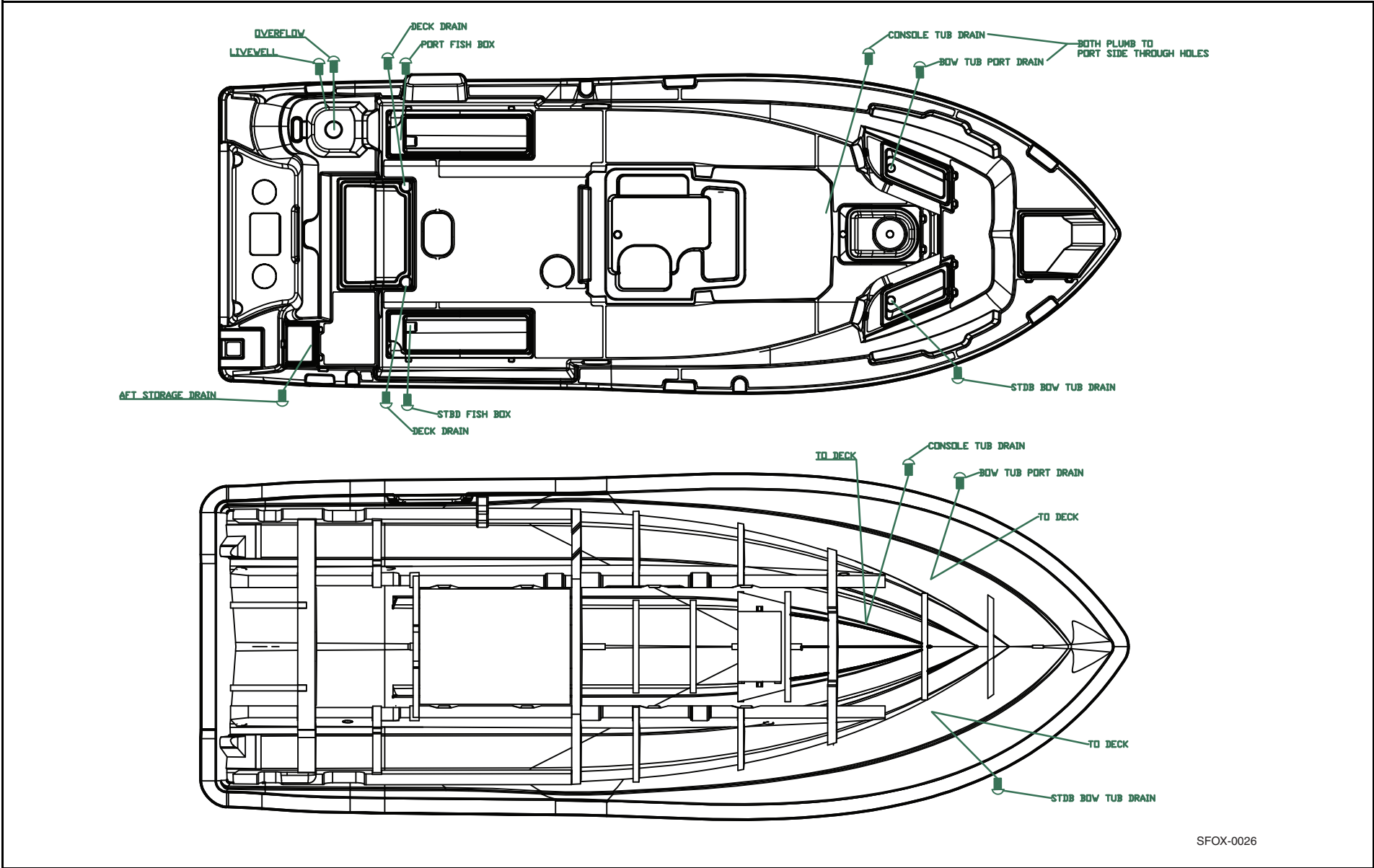

SFOX-0026

## COMMANDER WASTE SYSTEM

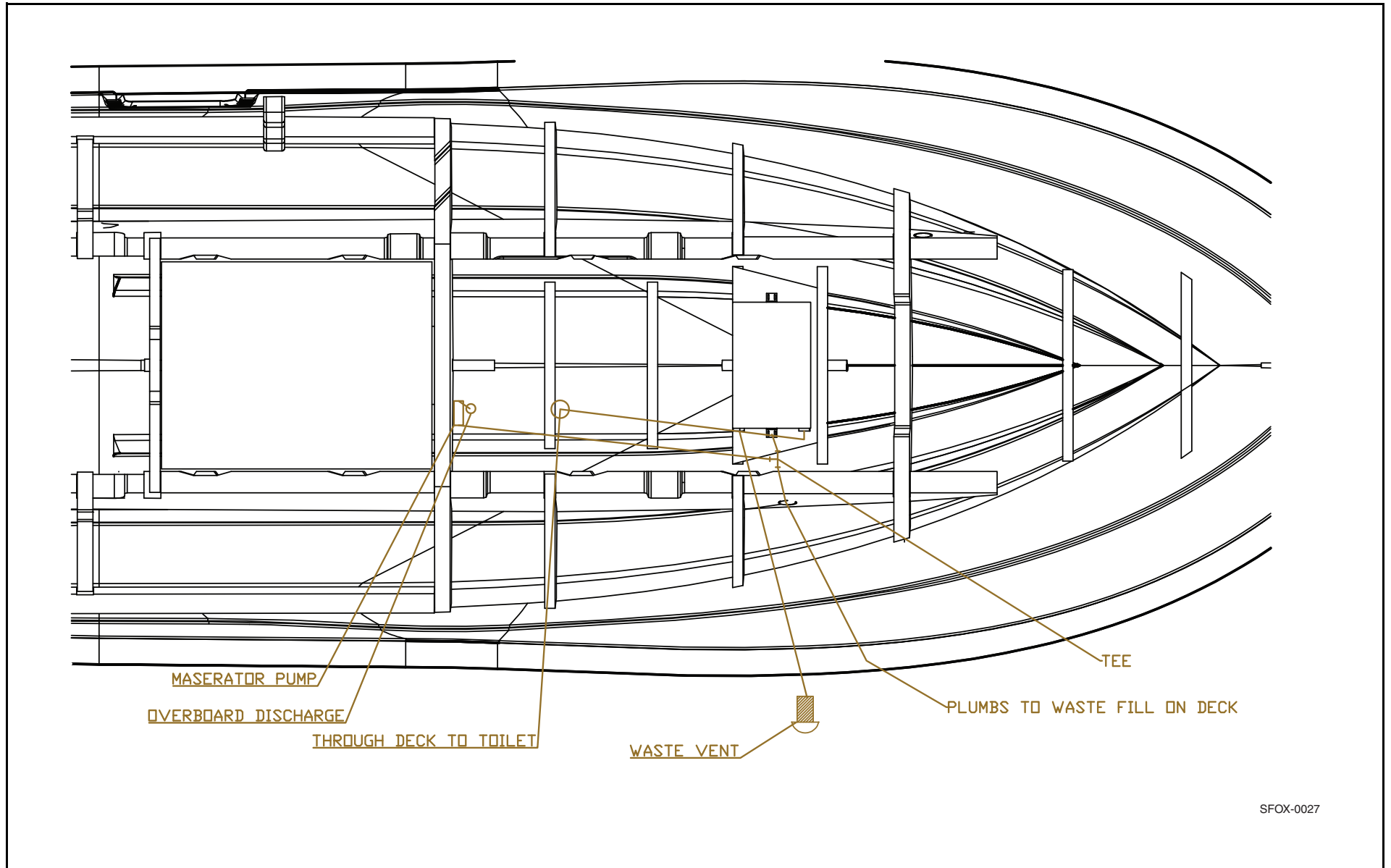

## COMMANDER FRESH WATER SYSTEM

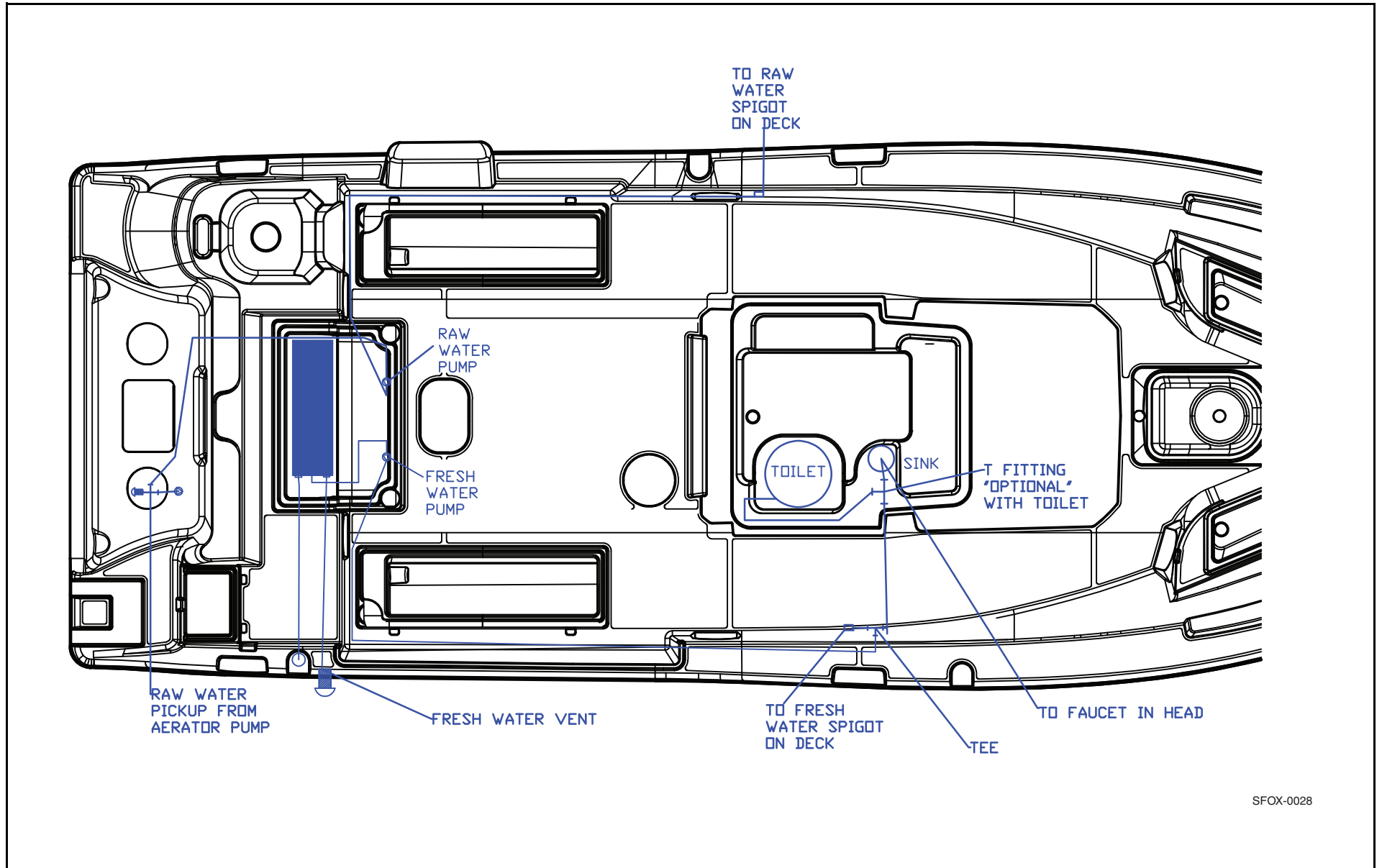

SFOX-0028

## COMMANDER FUEL SYSTEM

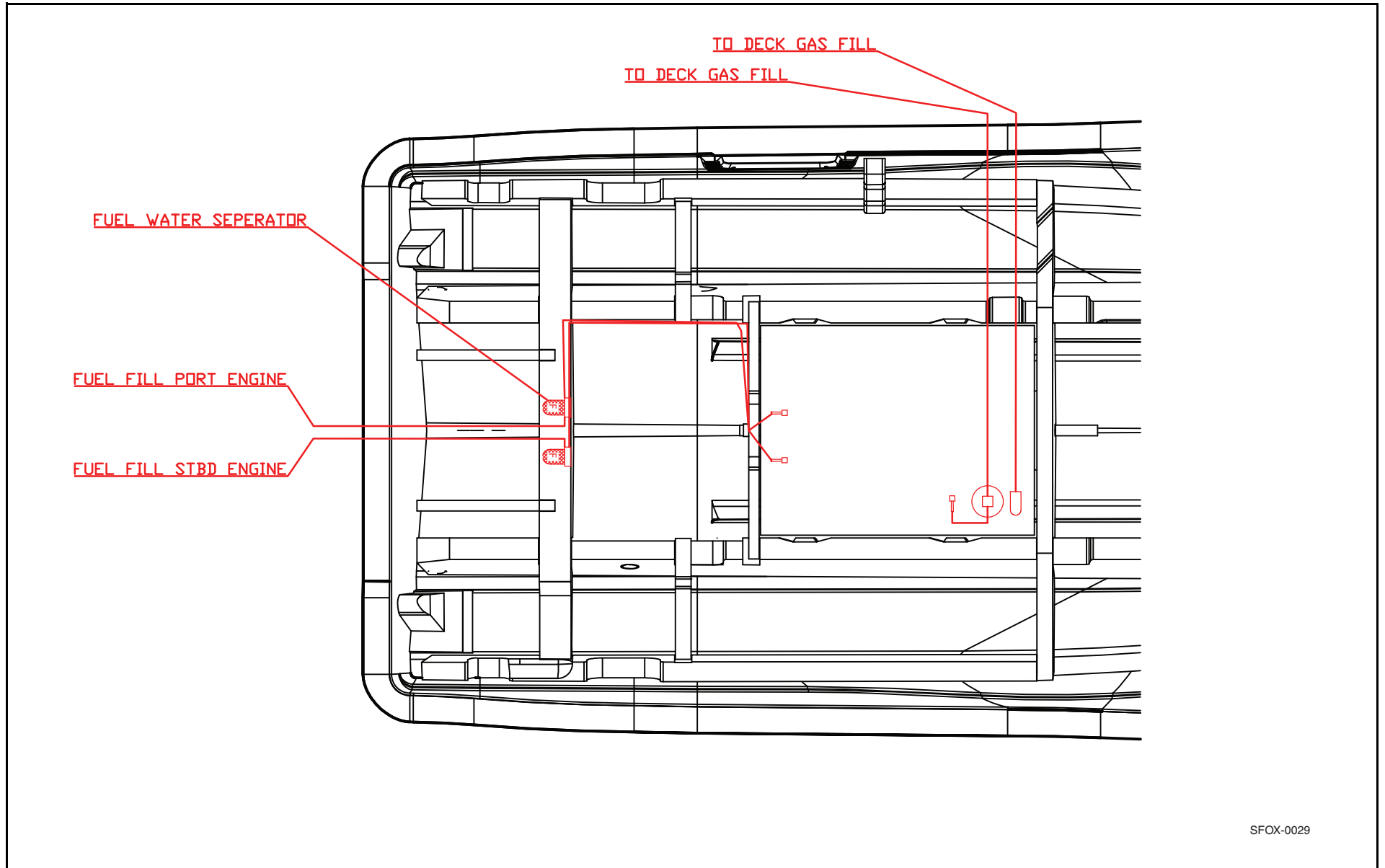

SFOX-0029

## ELECTRICAL SCHEMATICS

### SINGLE ENGINE WITH TWO-BATTERY SETUP

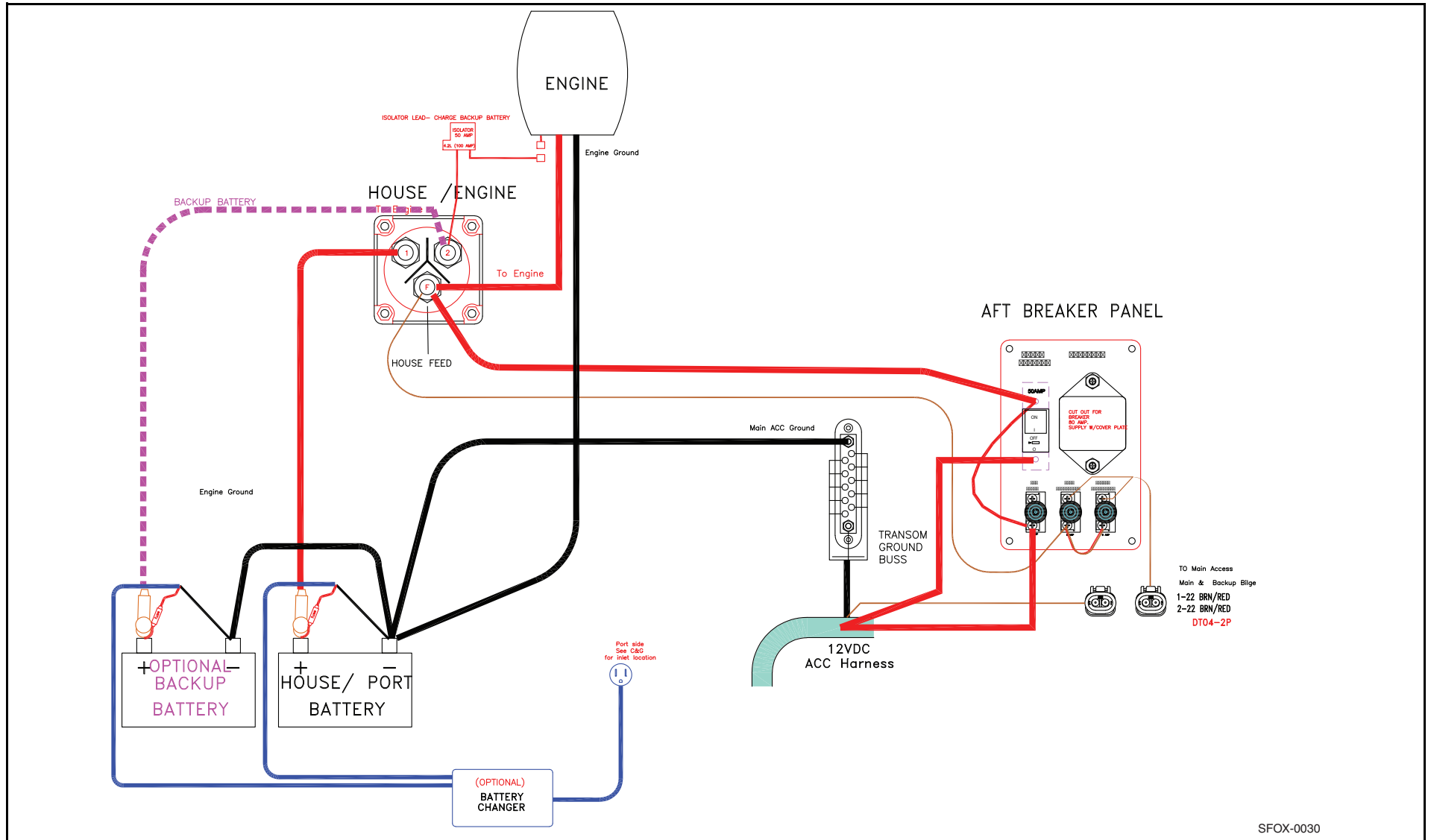

## TWIN ENGINE WITH THREE-BATTERY SETUP

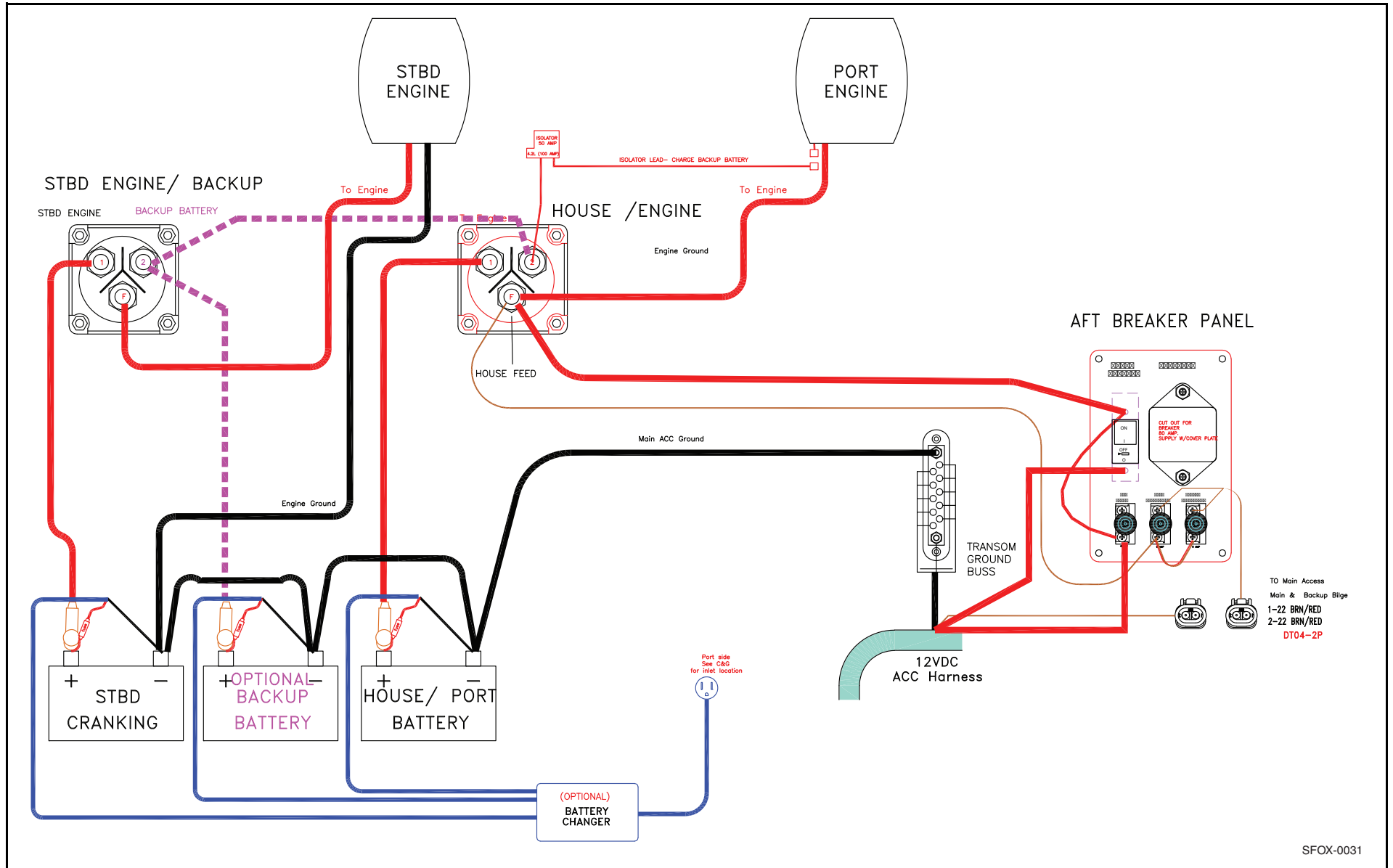

## HARNESS NAV LT LG W/DEUTSCH (P/N 6121)

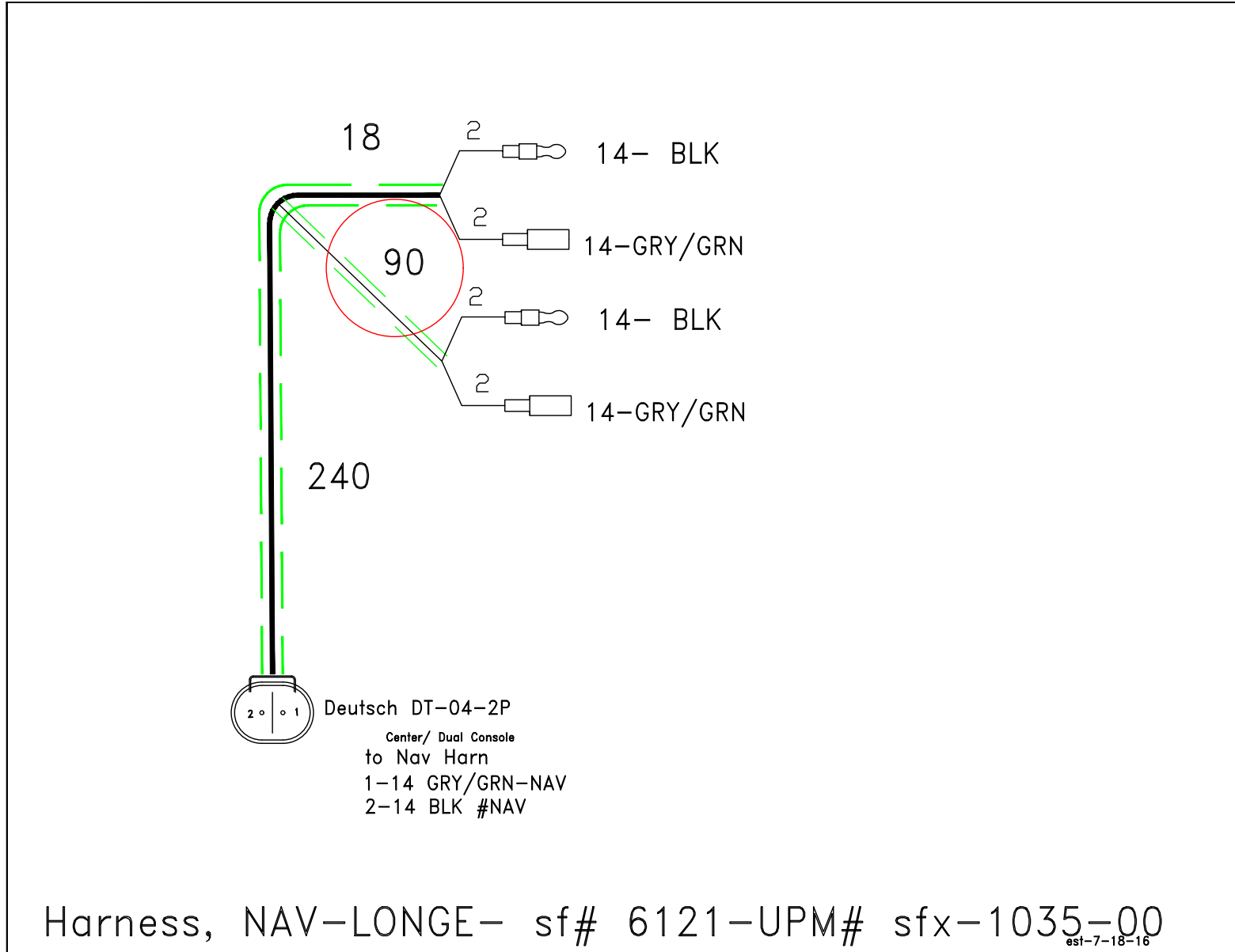



## ACCESSORY HARNESS

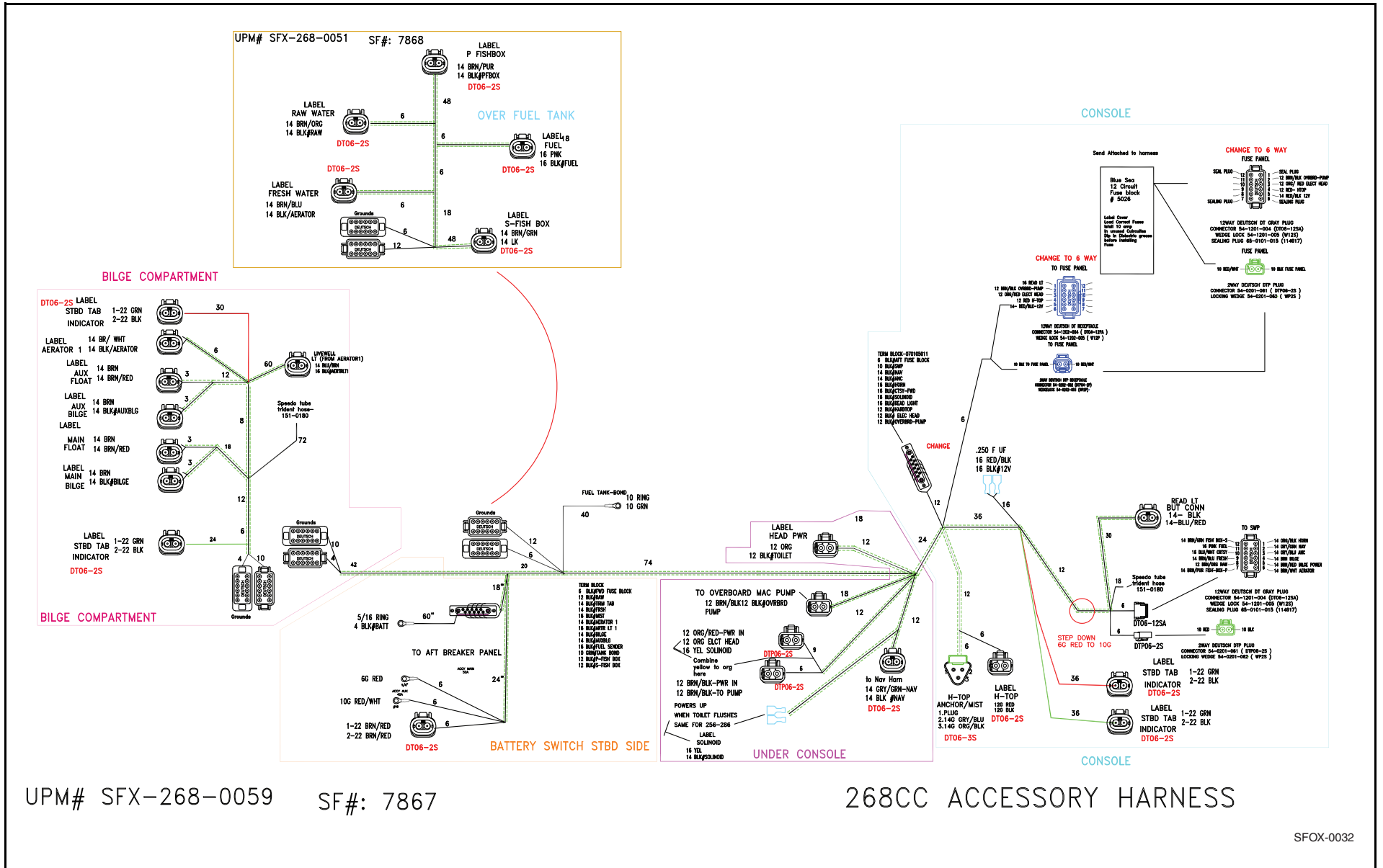

UPM# SFX-268-0059 SF#: 7867

268CC ACCESSORY HARNESS

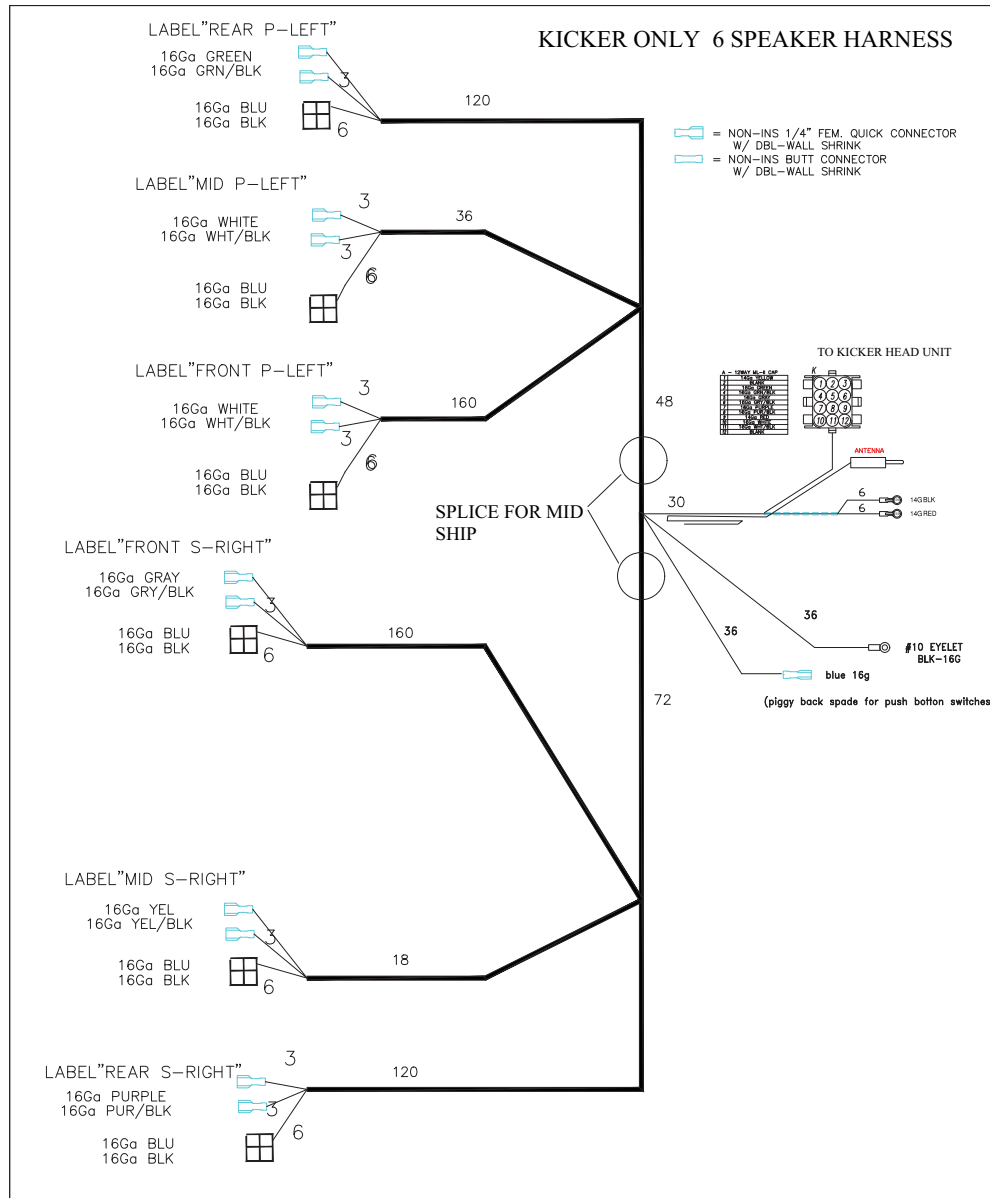

## HARNES JL 6-SPEAKER

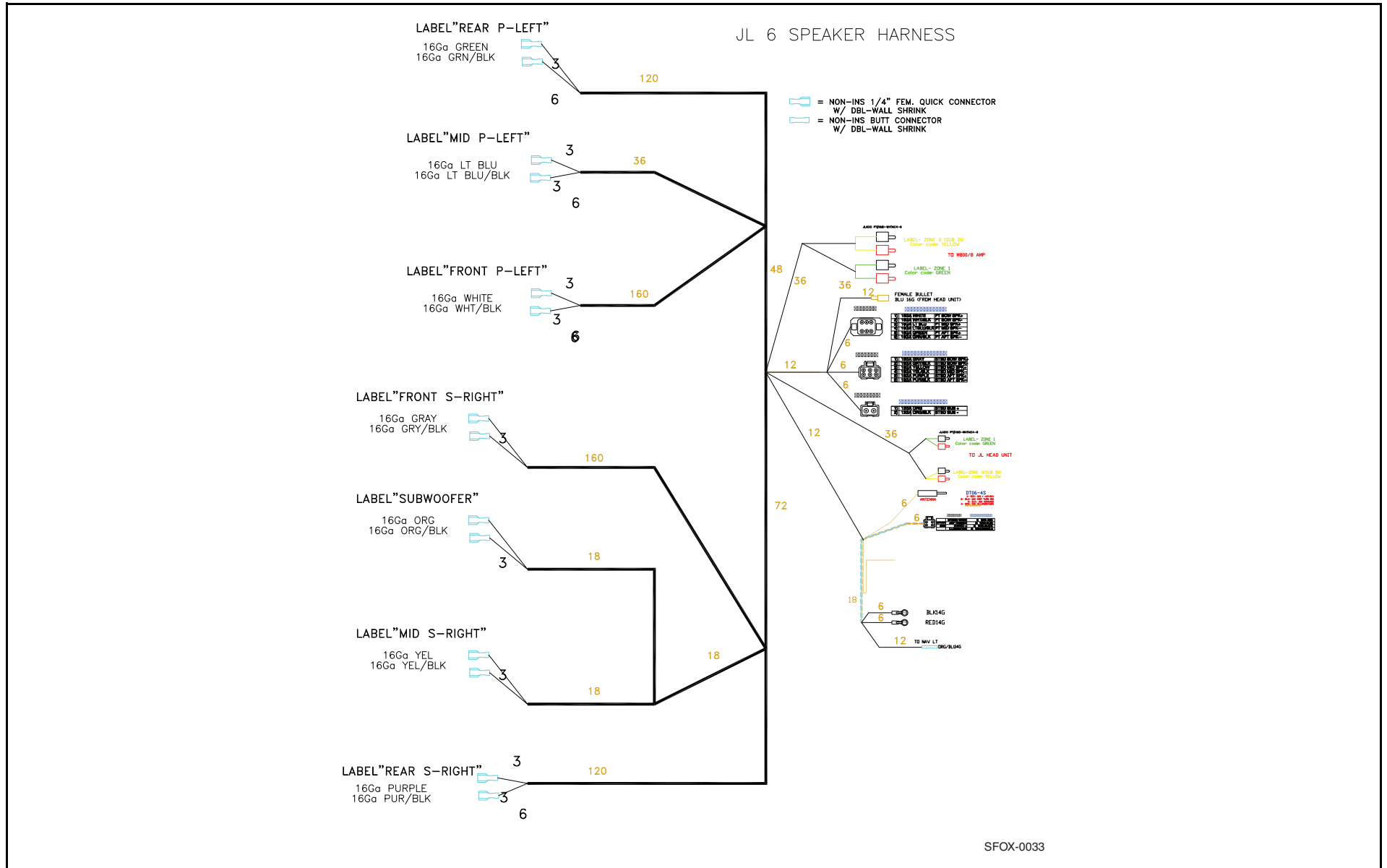

## MAIN SWITCH PANEL

PANEL- 268 UPM # SFX-268-0423B SEAFOX# 7871

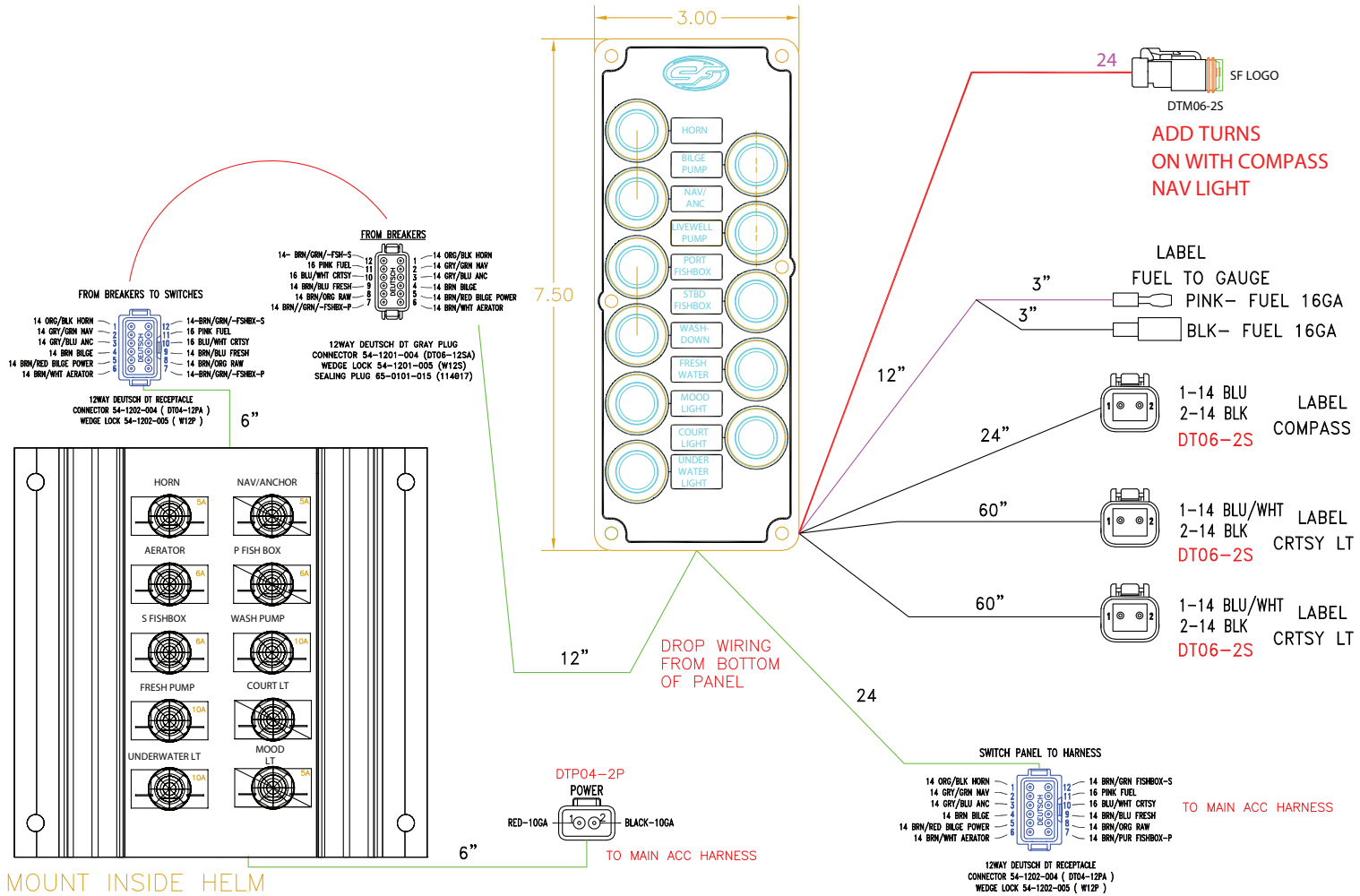

SFOX-0034

**JL AUDIO BREAKER PANEL**

# JL AUDIO BREAKER KIT LONG 800/8

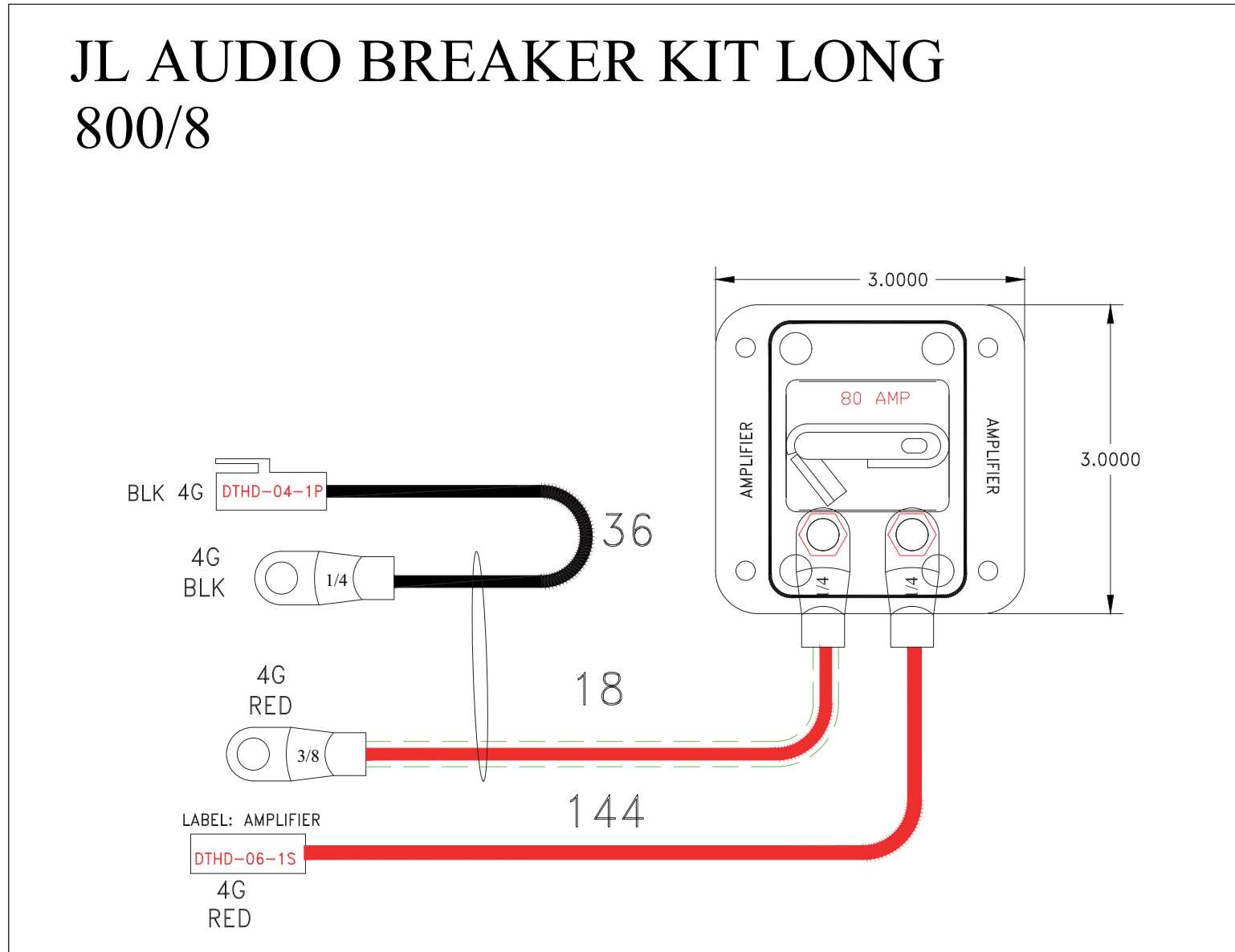

## JL AMPLIFIER PIG TAIL KIT

### JL AMPLIFIER PIG TAILS

TO M800/8 AMP  
ZONE 1 & 3

#### DECK PLUG (SUB) DTS06-2S

1)	12GA ORG	STBD SUB +
2)	12GA ORG/BLK	STBD SUB -



6

#### DECK PLUG (P) DT06-6S

1)	16GA WHITE	PT BOW SPK+
2)	16GA WHT/BLK	PT BOW SPK-
3)	16GA LT BLU	PT MID SPK+
4)	16GA LTBLU/BLK	PT MID SPK-
5)	16GA GREEN	PT AFT SPK+
6)	16GA GRN/BLK	PT AFT SPK-

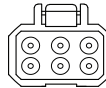

6

18

TO M800/8 AMP

STRIP WIRES ( NO TINED WIRE FOR SPEAKERS)

1)	16GA WHITE	PT BOW SPK+
2)	16GA WHT/BLK	PT BOW SPK-
3)	16GA PINK	PT MID SPK+
4)	16GA PINK/BLK	PT MID SPK-
5)	16GA GREEN	PT AFT SPK+
6)	16GA GRN/BLK	PT AFT SPK-
7)	16GA GRAY	STBD BOW SPK+
8)	16GA GRY/BLK	STBD BOW SPK-
9)	16GA YELLOW	STBD MID SPK+
10)	16GA YEL/BLK	STBD MID SPK-
11)	16GA PURPLE	STBD AFT SPK+
12)	16GA PUR/BLK	STBD AFT SPK-
13)	12GA ORG	MID SUB WOOFER +
14)	12GA ORG/BLK	MID SUB WOOFER -
15)	16GA BLUE	TRIGGER ON +
16)	4GA BLK	GROUND-
17)	4GA RED	POWER +

#### DECK PLUG (SS) DT04-6P

1)	16GA GRAY	STBD BOW SPK+
2)	16GA GRY/BLK	STBD BOW SPK-
3)	16GA YELLOW	STBD MID SPK+
4)	16GA YEL/BLK	STBD MID SPK-
5)	16GA PURPLE	STBD AFT SPK+
6)	16GA PUR/BLK	STBD AFT SPK-

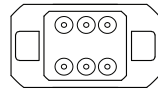

6

DTHD-04-1P RED 4G

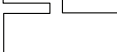

6

DTHD-06-1S BLK 4G

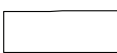

6

BLU/WHT- 16GA



SFX-331-328  
AMPLIFIER, PIG TAIL KIT 24-26ft

SFOX-0035

**HARNES MOOD LIGHT W/DEUTSCH (P/N 6128) – OPTIONAL**

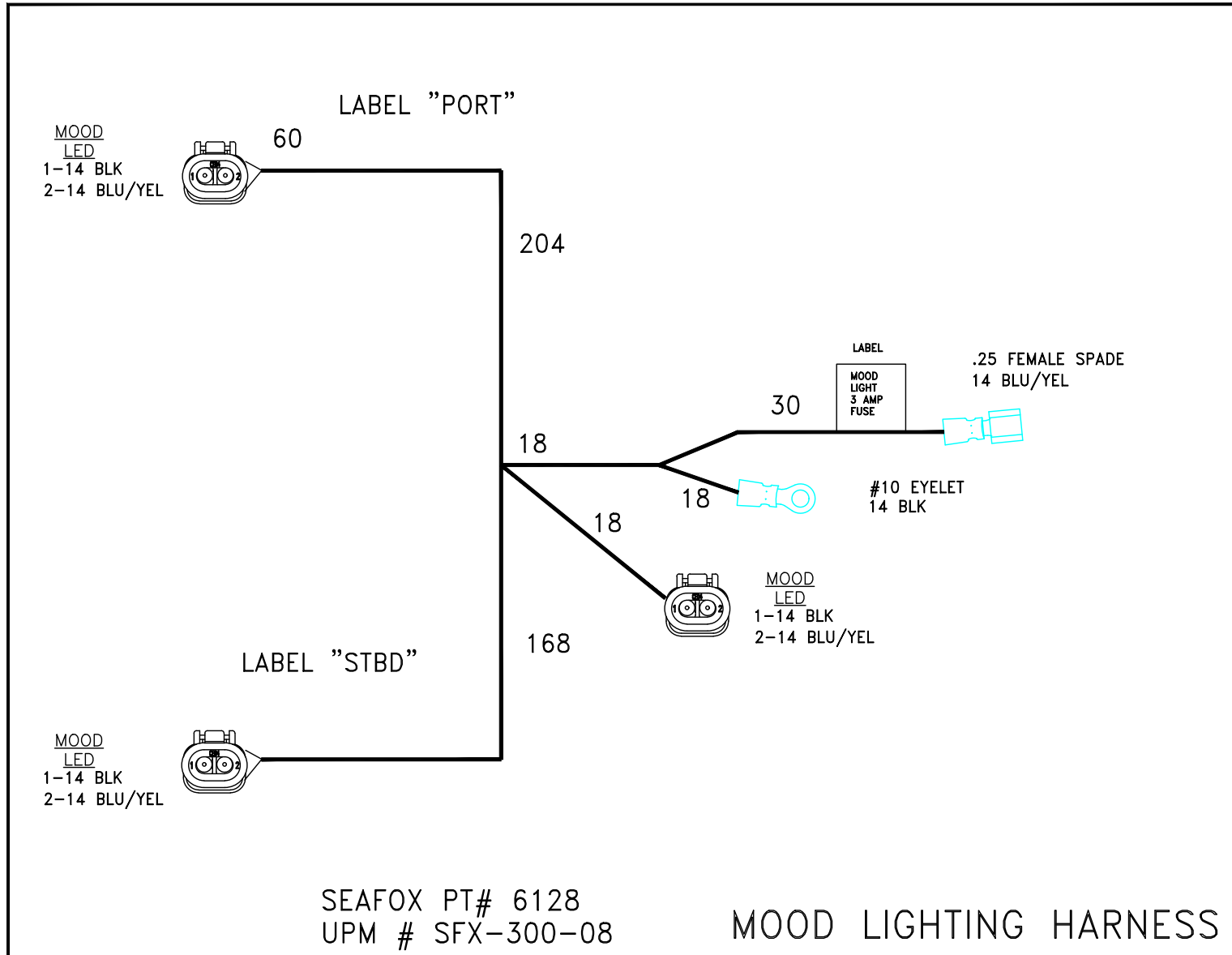

## HARNESS WINDLASS HULL AFT BATTERY (P/N 6134) – OPTIONAL

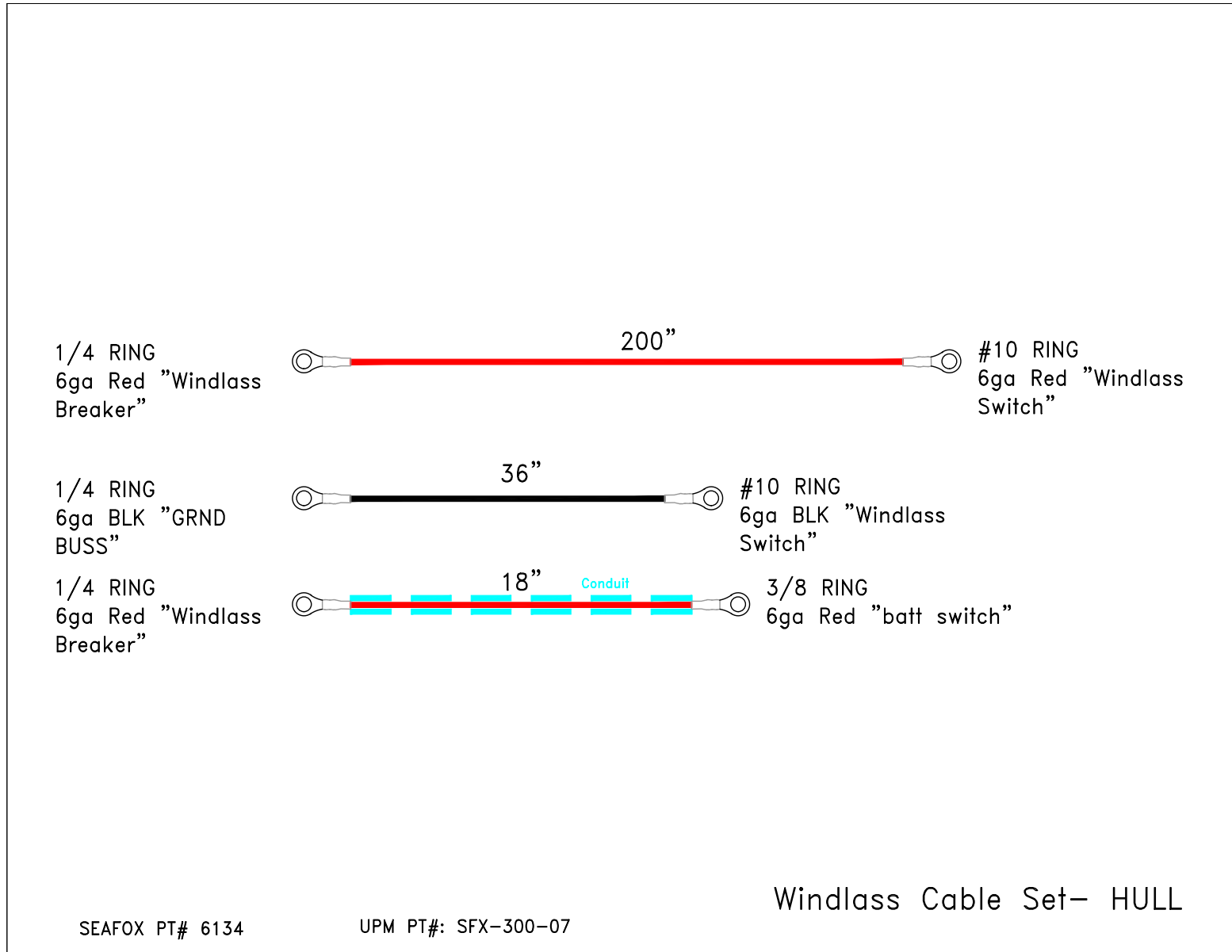



**HARNES WINDLASS DECK OPTION (P/N 6135) – OPTIONAL**

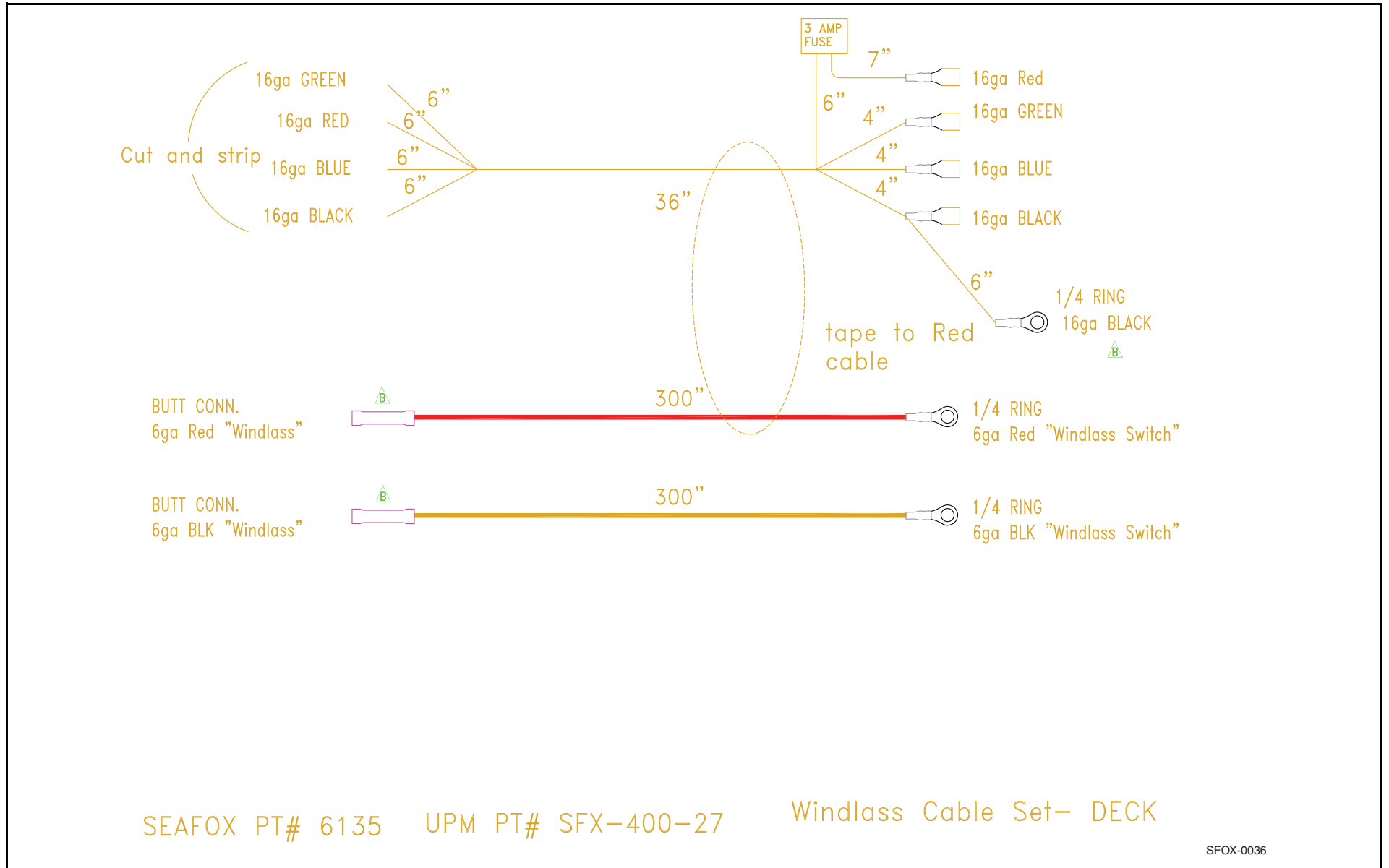

## HEAD PANEL SWITCH ORB (P/N 6136) – OPTIONAL

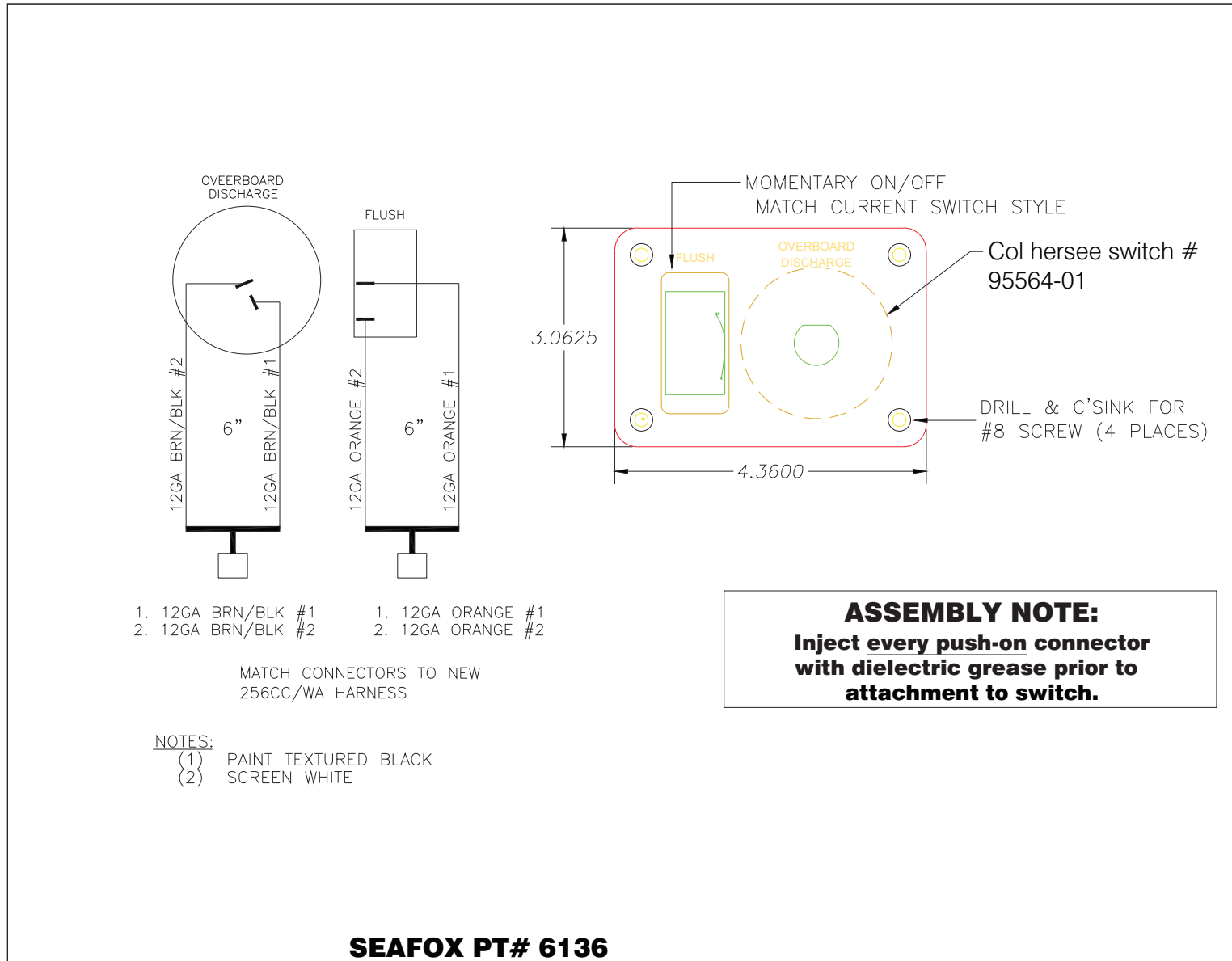

## AFT MAIN BREAKER PANEL

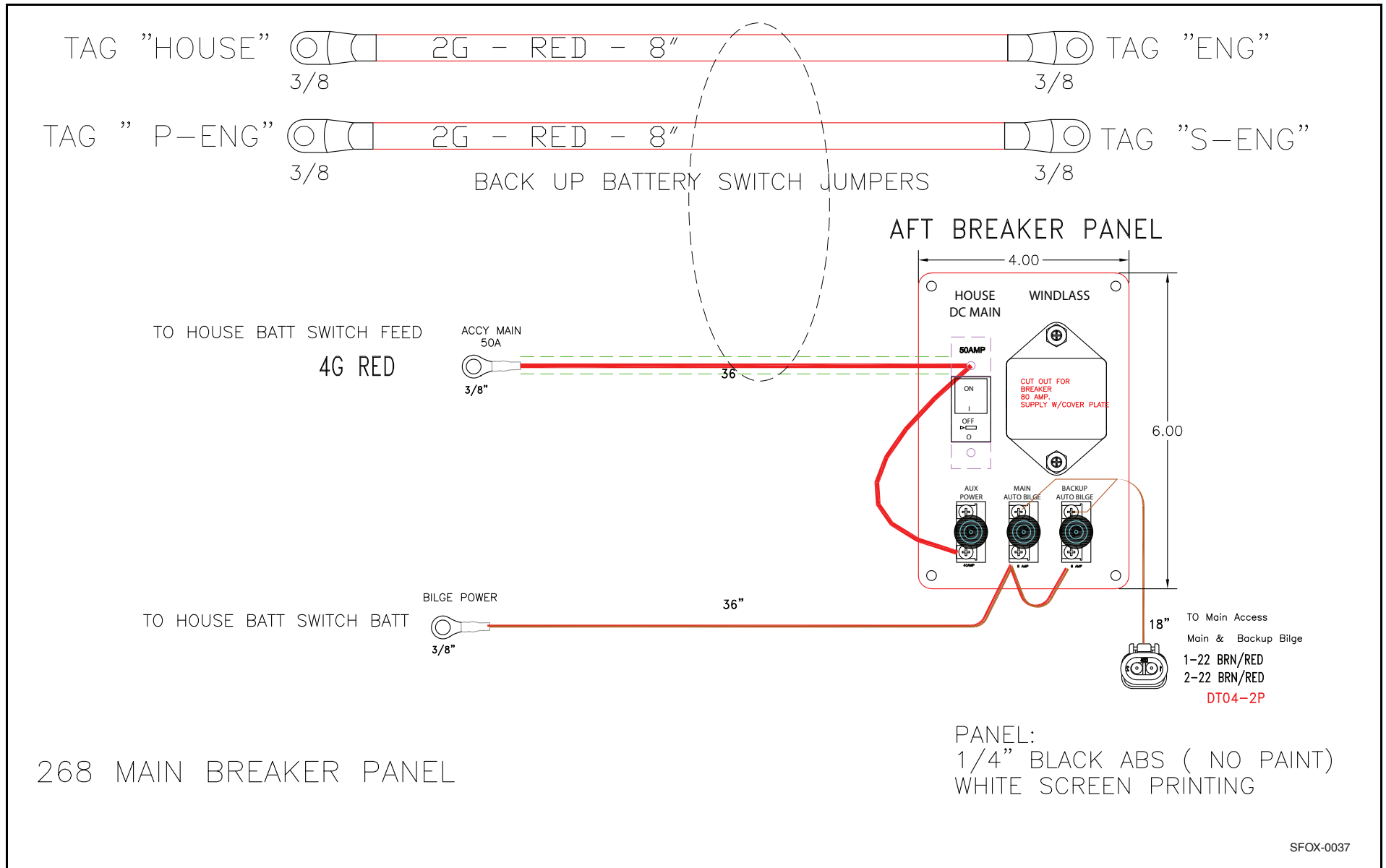

## ULTIMA TOP SWITCH/HARNESS (P/N 7277) – OPTIONAL

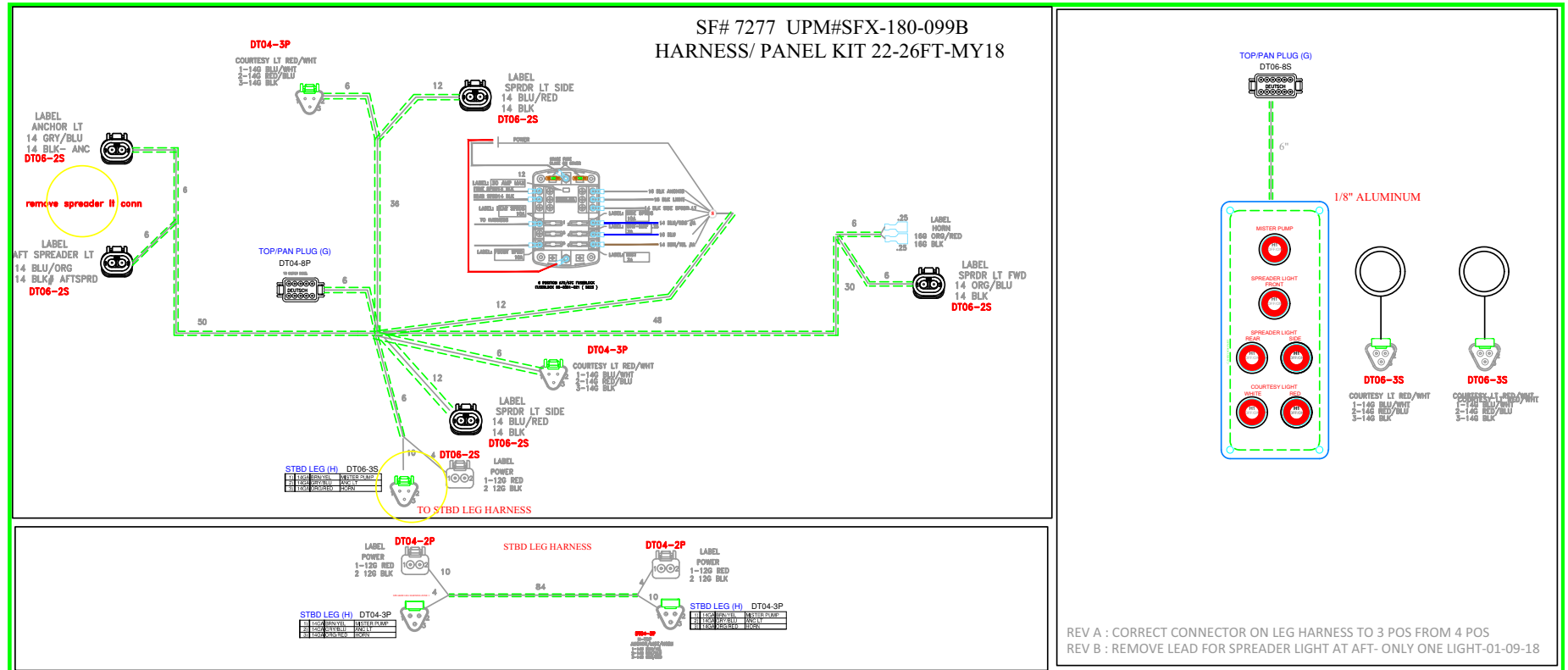







# SEA FOX

BOAT WORKS

**Sea Fox Boat Company, Inc.**  
2550 Highway 52  
Moncks Corner, SC 29461-5024

Telephone: 843-761-6090  
[www.seafoxboats.com](http://www.seafoxboats.com)

Ken Cook Co.  
Printed in U.S.A.  
Rev 0224